

Stilt Lamp Collection

DESIGNED IN 2007

ASSEMBLY NOTES | REV 00

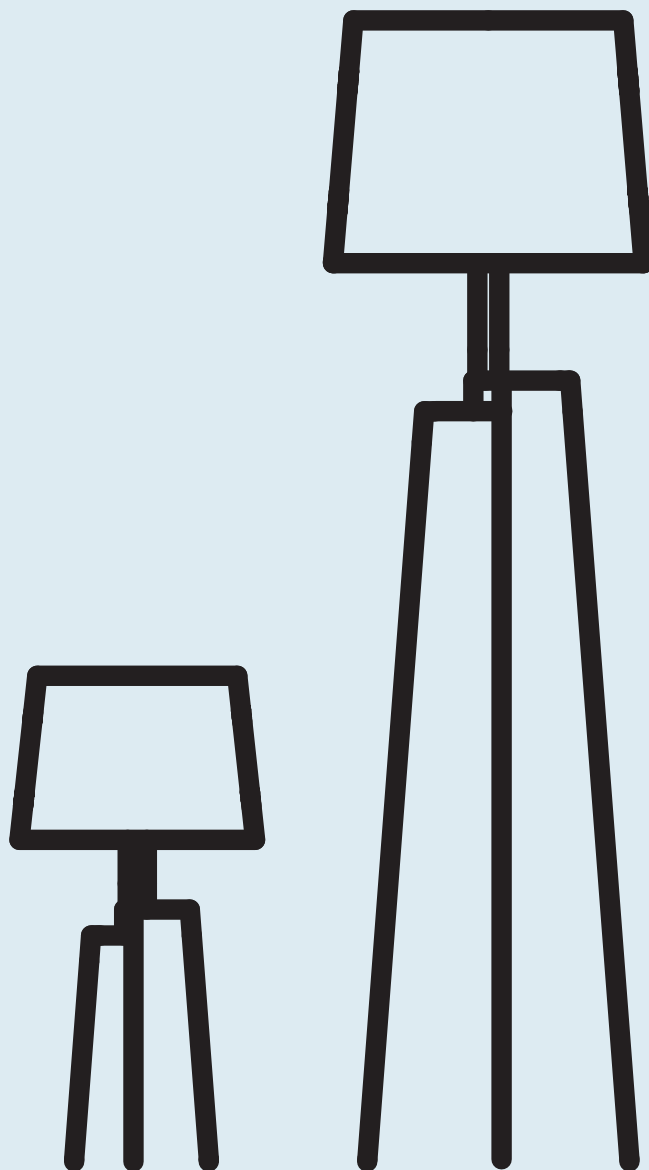
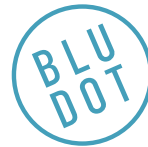

BRIGHTEN THE CORNERS. BOOK CLUB IS NEXT WEEK.

Traditional woodworking joinery takes on a different light when slender legs pirouette open to form one well-poised base.

NEED A HAND?

Contact us at service@bludot.com or **844.425.8368** for assistance.

Parts & Hardware

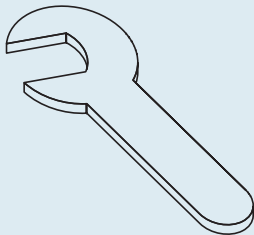

QTY 1

Pt. 9008

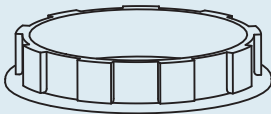

QTY 1

Collar

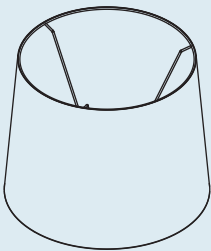

QTY 1

Shade

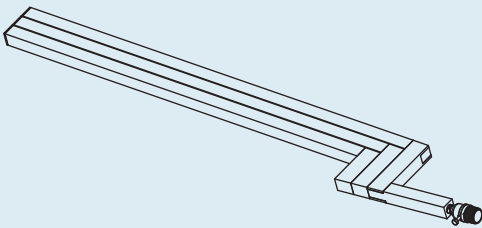

QTY 1

Base

Step 01

ROTATE BASE LEGS.

Ensure socket is not plugged into an outlet during assembly. Rotate base legs evenly. Use the provided wrench to secure legs once in position.

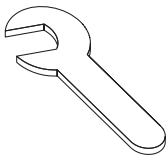
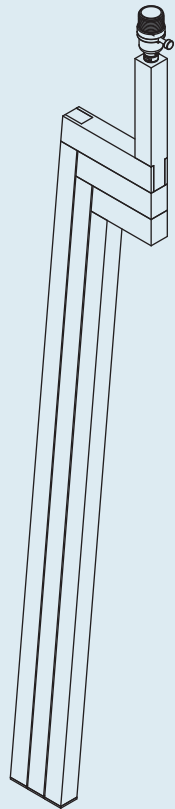
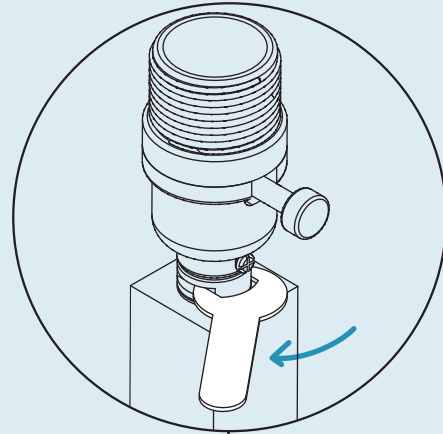

PT. 9008 x 1

Step 02

INSTALL SHADE AND BULB.

Place shade on the socket as shown. Place the provided collar on socket and turn clockwise to secure. Screw light bulb into socket.

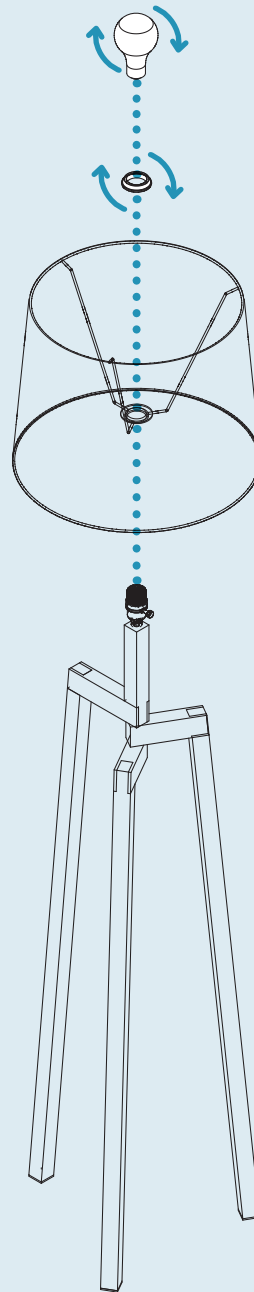

Additional Information

NOTE

A light bulb is provided. We recommend using an incandescent (100W maximum) or LED equivalent bulb.

CLEAN

Unplug lamp prior to cleaning. Clean with a high quality cleaner formulated for wood products.

