

# Skiff Small Cafe Table

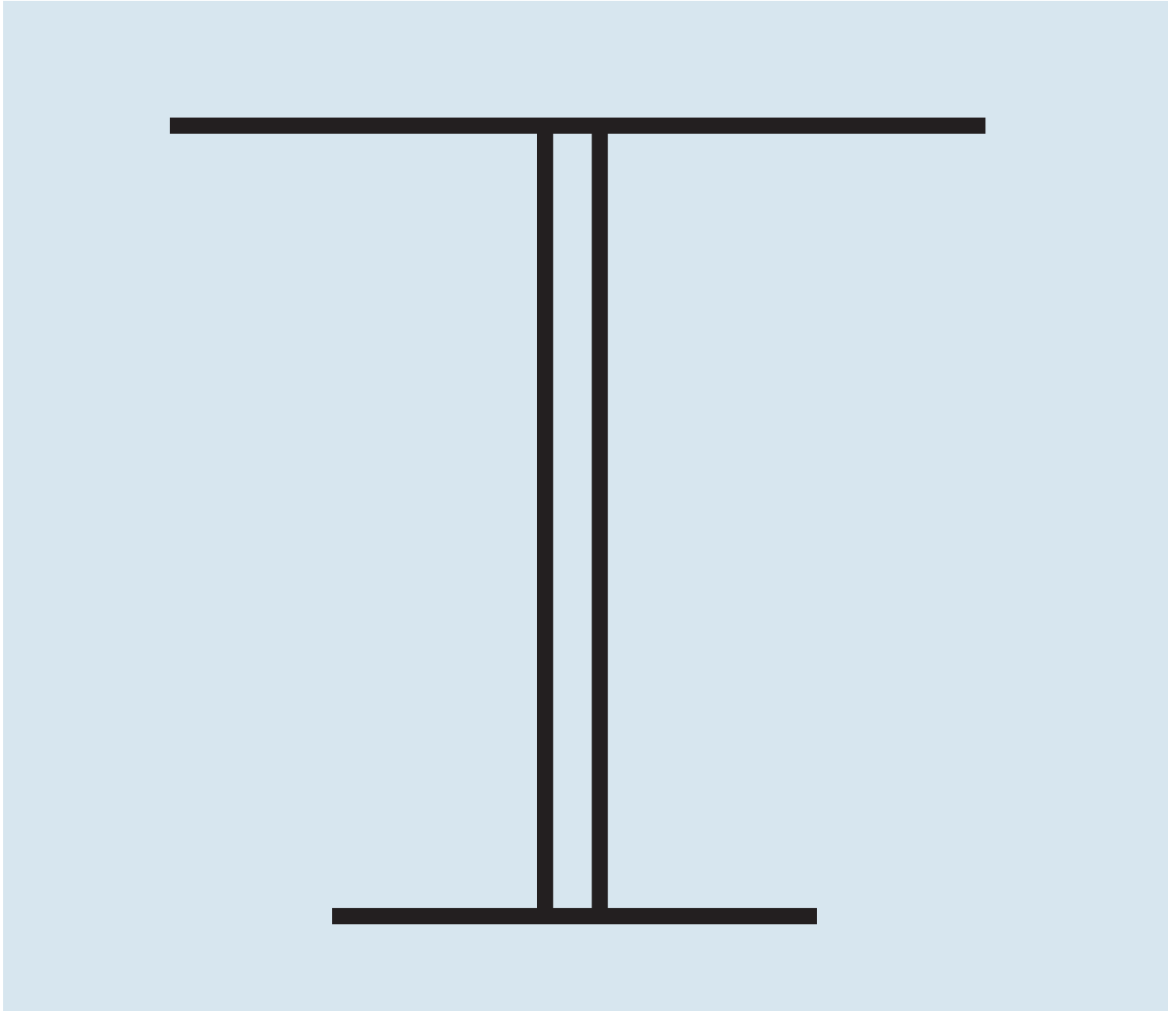

DESIGNED IN 2012

ASSEMBLY NOTES | REV 00



## WHITE HEAT.

Crisp minimal white powder-coated aluminum and solid laminate top.  
Clean lines designed to weather the elements.

## NEED A HAND?

Contact us at [service@bludot.com](mailto:service@bludot.com) or  
**844.425.8368** for assistance.

# Parts & Hardware

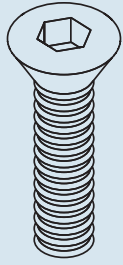

QTY

3

Pt. 1087

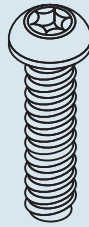

QTY

3

Pt. 1086

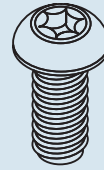

QTY

4

Pt. 1088

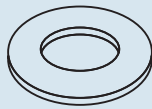

QTY

7

Pt. 3012

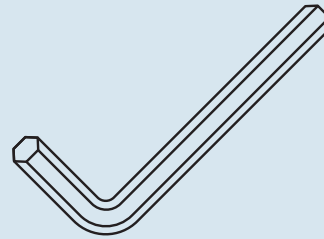

QTY

1

Pt. 9004

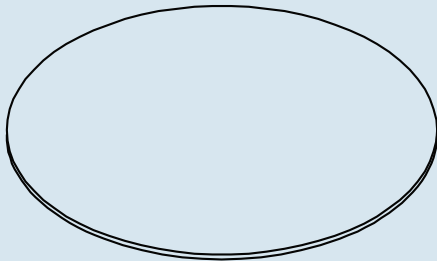

QTY

1

Top Panel

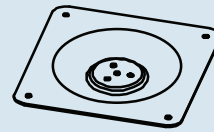

QTY

1

Metal Plate



QTY

1

Support Column

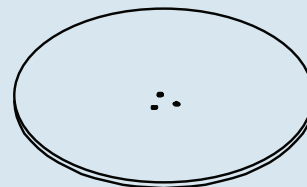

QTY

1

Base Plate

## Step 01

### ATTACH METAL PLATE.

Attach metal plate to support column as shown using the provided hardware.

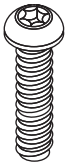
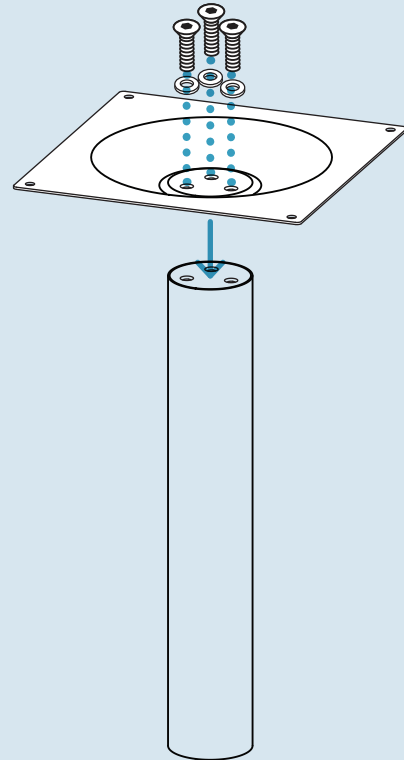

PT. 1086 x 3



PT. 3012 x 3

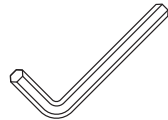

PT. 9004 x 1

## Step 02

### ATTACH BASE PLATE.

Attach base plate to support column as shown using the provided hardware.

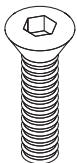
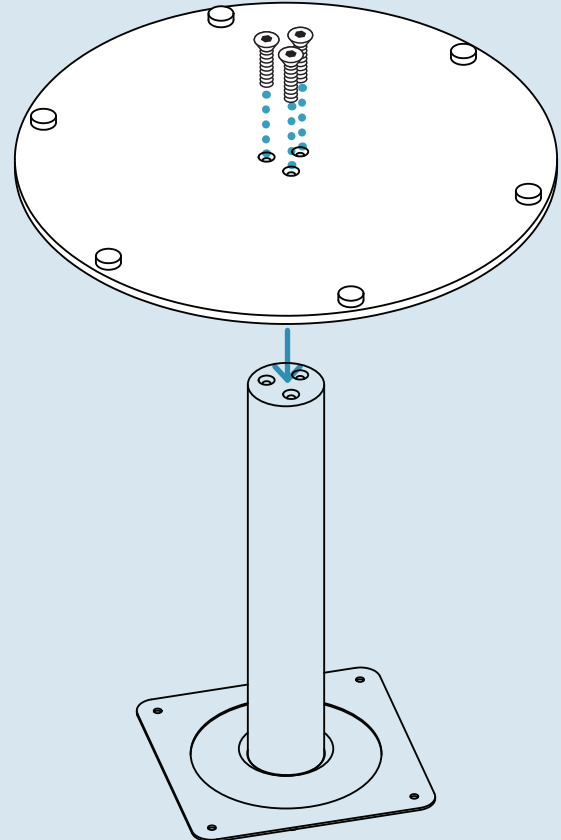

PT. 1087 x 3

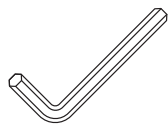

PT. 9004 x 1

# Step 03

## ATTACH TOP PANEL.

Attach base assembly to table top as shown using the provided hardware.

NOTE: Place table top on carpet or similarly soft surface to protect from scratches during assembly.

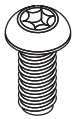
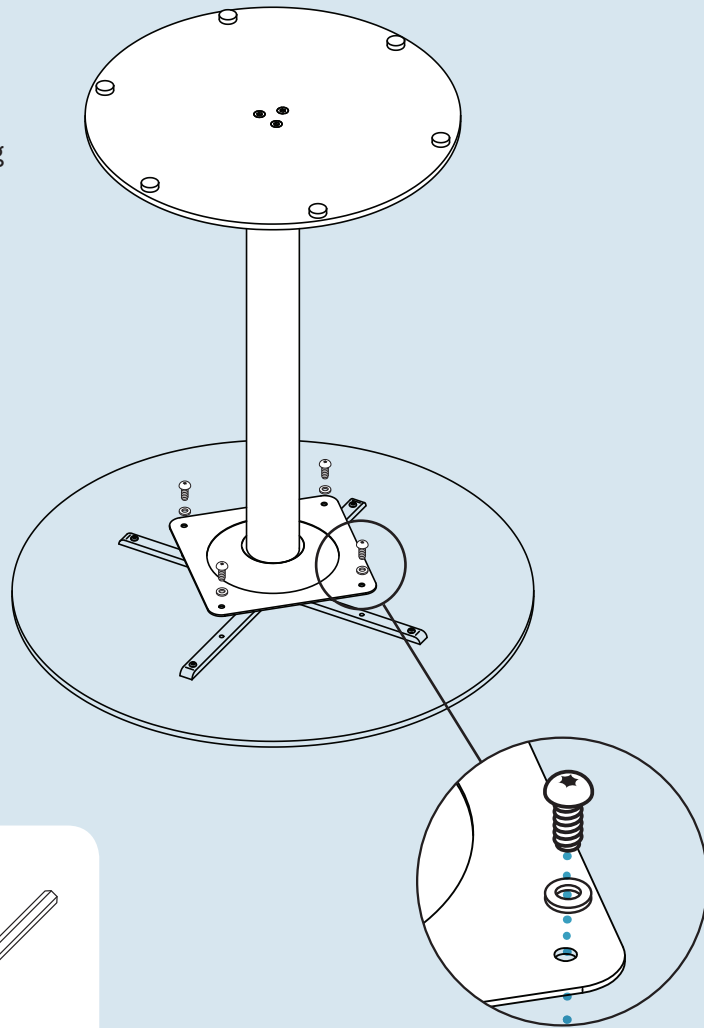

PT. 1088 x 4



PT. 3012 x 4

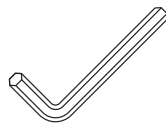

PT. 9004 x 1

## Additional Information

### CLEAN

Clean with a slightly damp, soft cloth. To remove dirt and fingerprints use warm water and a mild detergent, such as dish soap. Wipe dry with a soft cloth.

### PROTECT

Cover or store inside during the winter months.

