

Real Good Stool

DESIGNED IN 2007

ASSEMBLY NOTES | REV 00

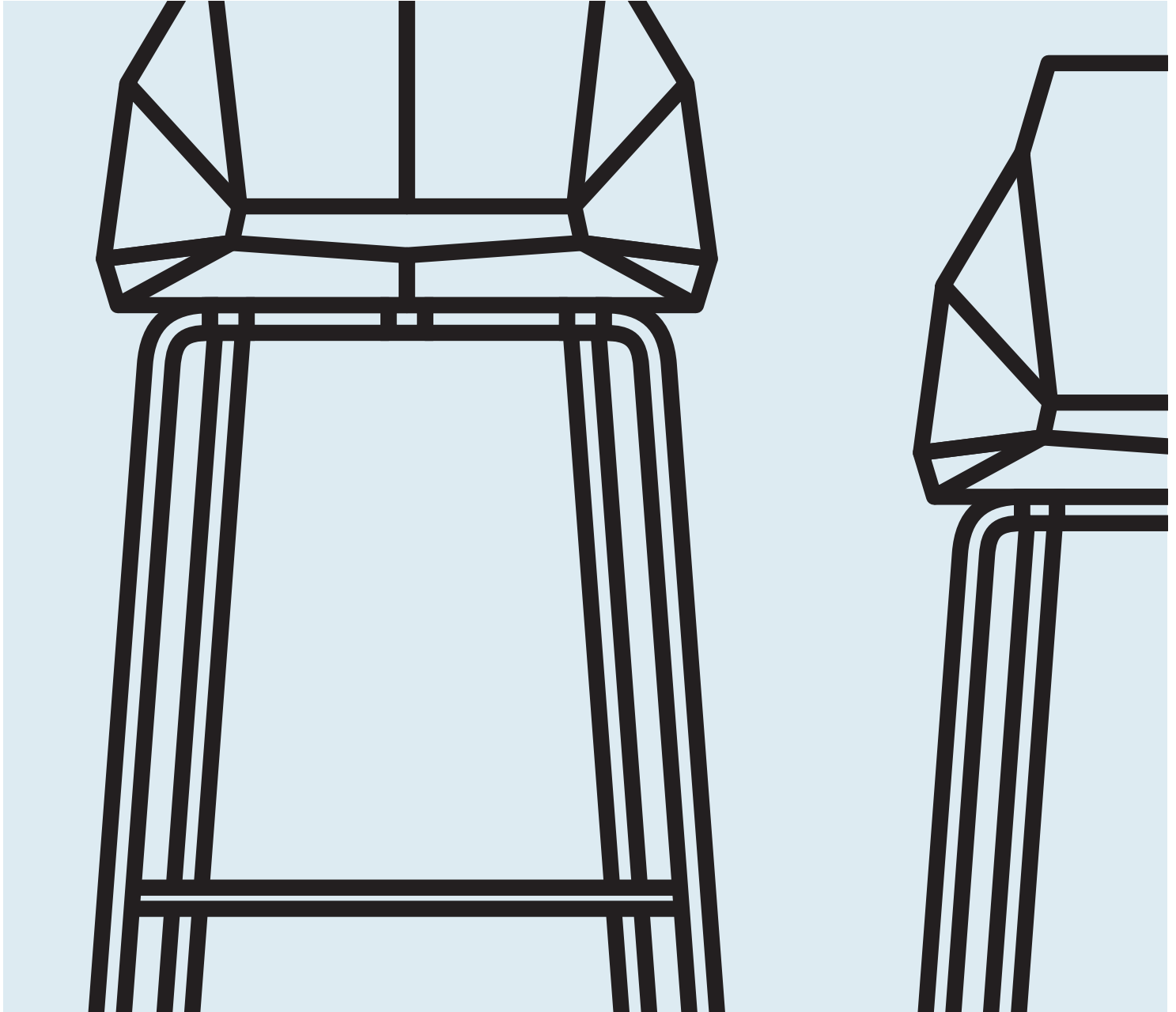

NEED A HAND?

Contact us at service@bludot.com or
844.425.8368 for assistance.

@BLUDOT

We design all our pieces in our Minneapolis studio. Follow
along on Instagram for some sneak peeks into the process.

Parts & Hardware

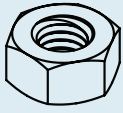

QTY 4

Pt. 2008

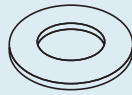

QTY 4

Pt. 3002

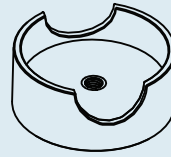

QTY 4

Pt. 8032



QTY 4

Pt. 8033

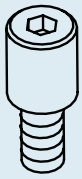

QTY 4

Pt. 1110

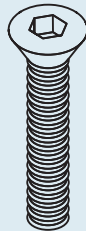

QTY 4

Pt. 1228



QTY 1

Pt. 9032

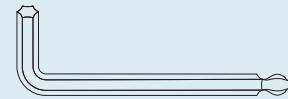

QTY 1

Pt. 9017

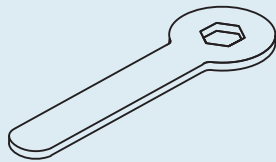

QTY 1

Pt. 9034

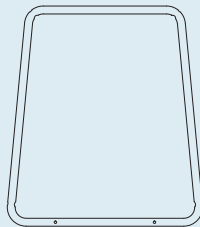

QTY 1

Foot Rest

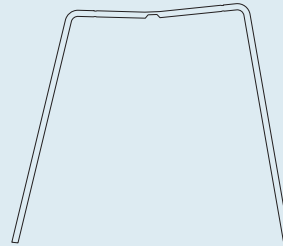

QTY 1

Upper Leg

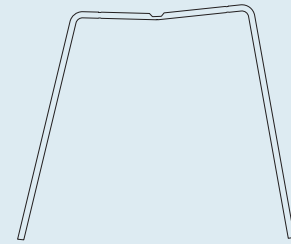

QTY 1

Lower Leg

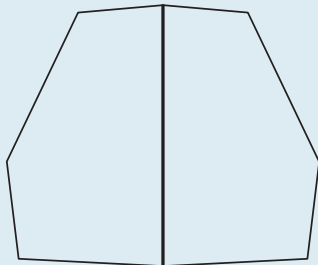

QTY 1

Seat

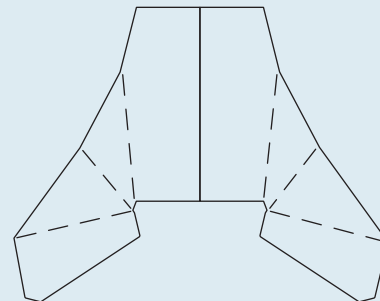

QTY 1

Back

Step 01

CUT OUT ANGLE GUIDE.

Cut out angle guide from cardboard carton for referencing the bend angles. Review the angle guide below for angle locations.

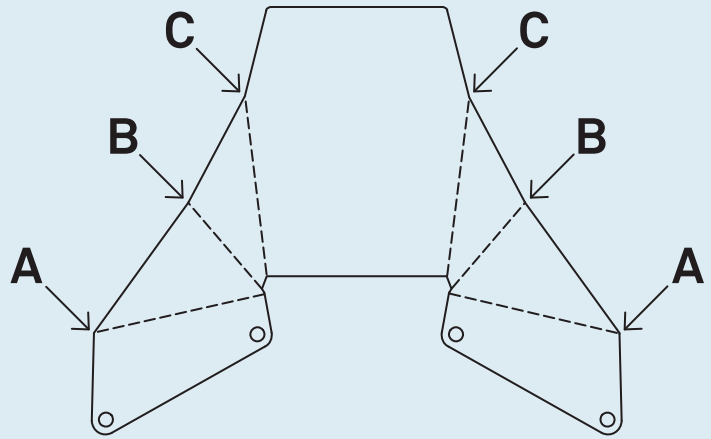
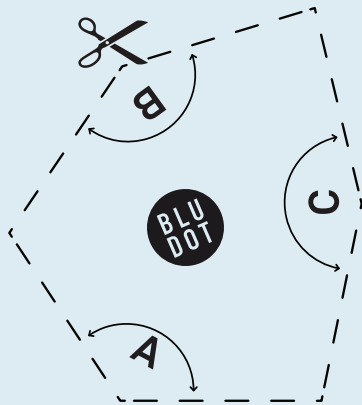

Step 02

BEND BACK PANEL.

Bend the angles on the back panel using the angle guide as shown.

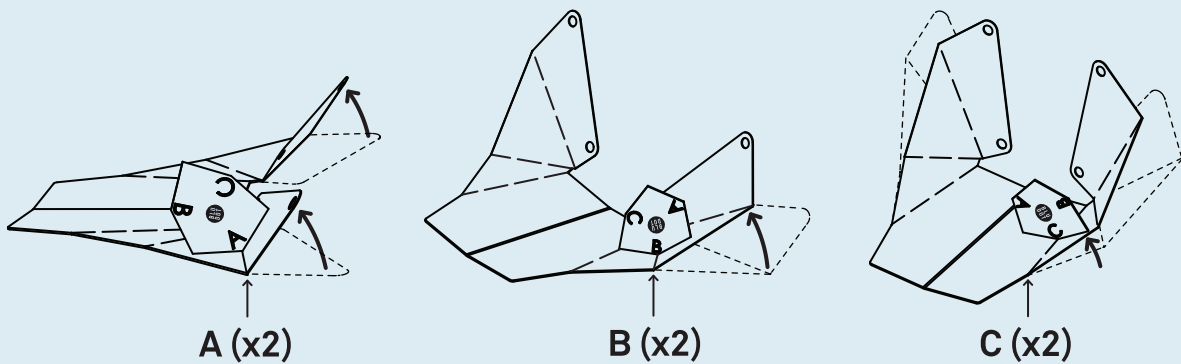

Step 03

ATTACH BACK PANEL TO SEAT.

Attach the back panel to the seat using the provided hardware as shown.

Do not fully tighten the bolts.

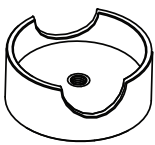
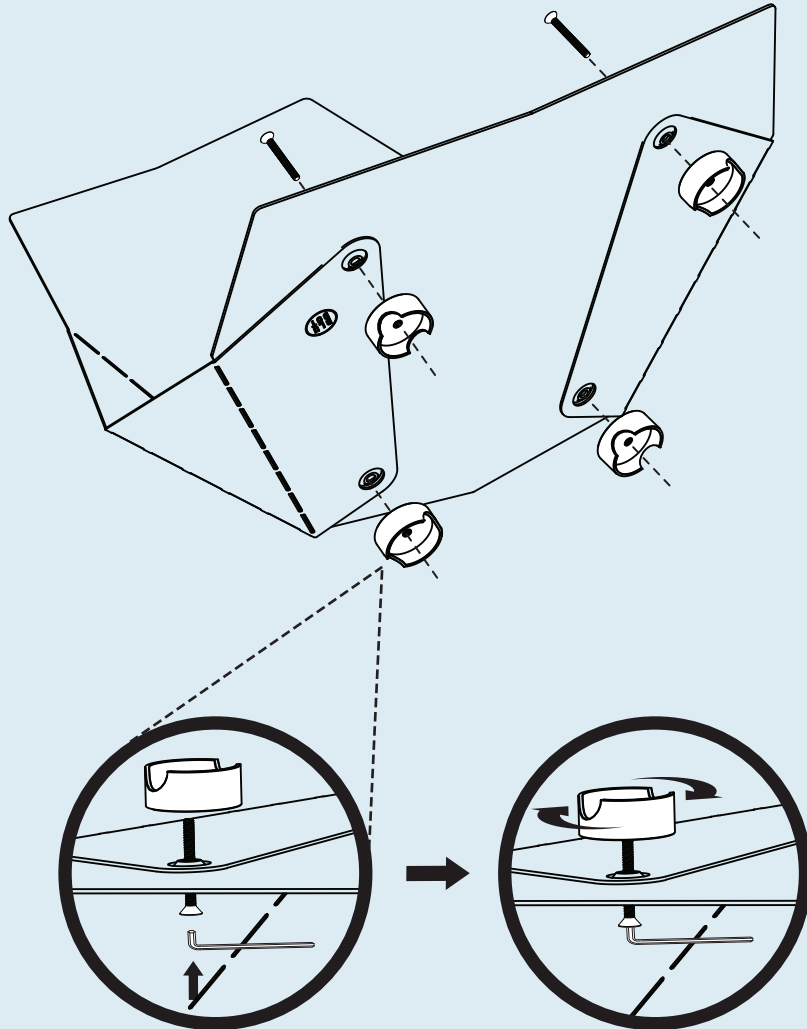

PT. 8032 x 4



PT. 1228 x 4



PT. 9032 x 1

Step 04

ALIGN PLASTIC SOCKETS.

Rotate the plastic sockets so they are aligned to receive leg assemblies as shown.

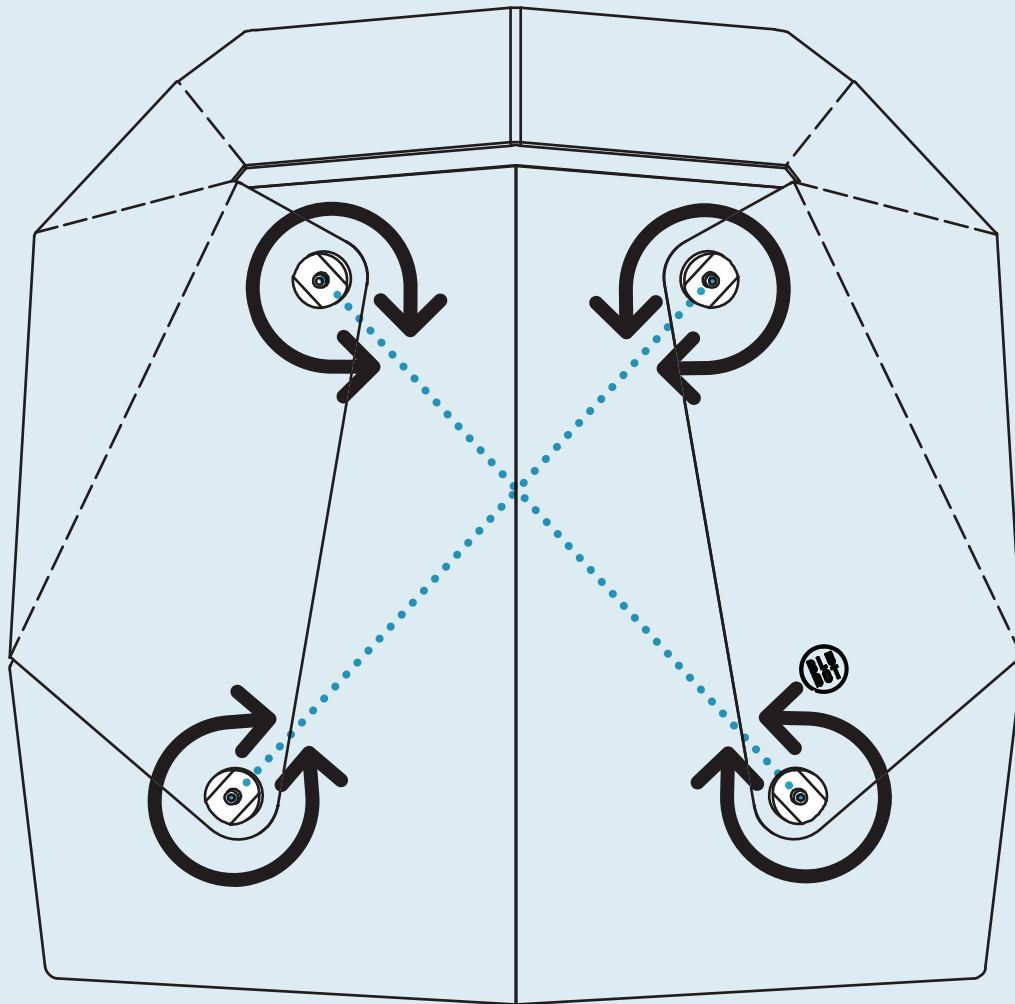

Step 05

ATTACH UPPER LEG.

Attach the upper leg to the seat assembly using the provided hardware as shown. Ensure that the correct leg is being attached by referencing the diagram below.

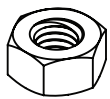
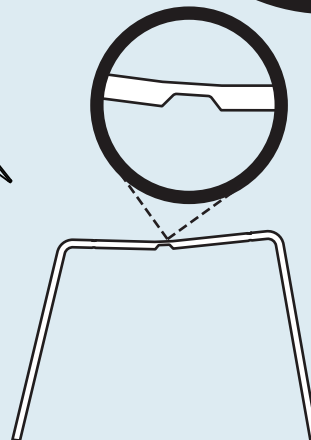
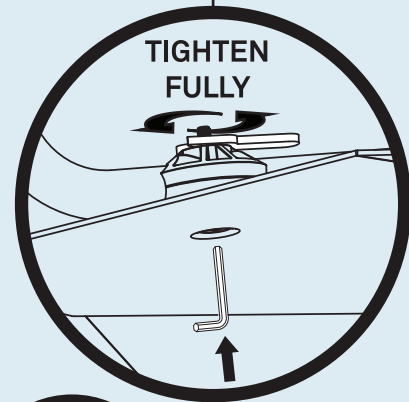
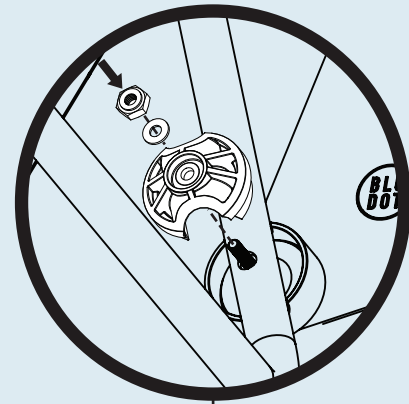
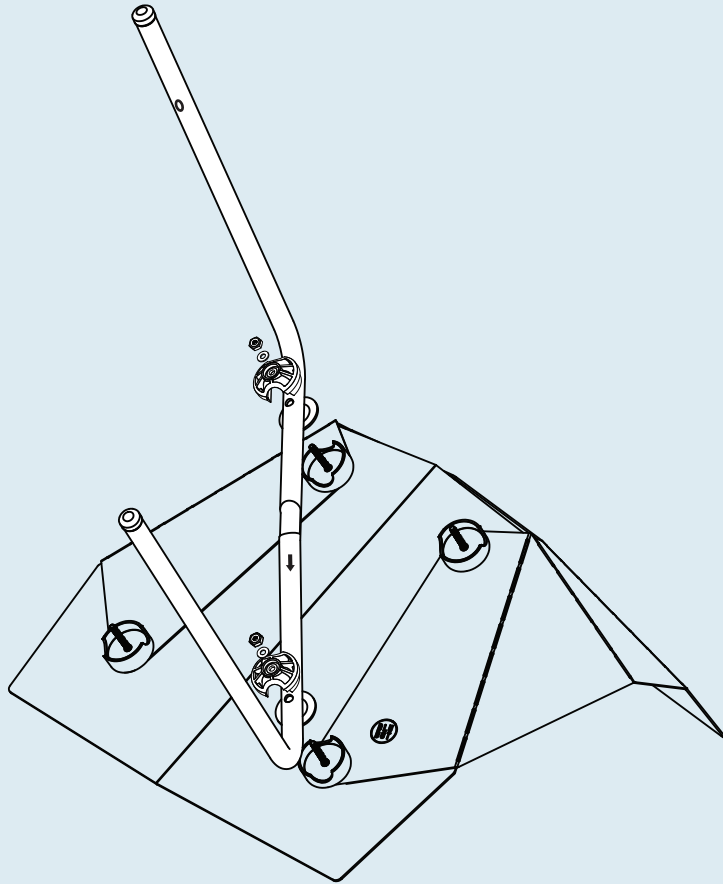

PT. 2008 x 2

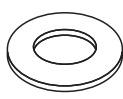

PT. 3002 x 2



PT. 8033 x 2

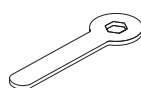

PT. 9034 x 1



PT. 9032 x 1

Step 06

ATTACH LOWER LEG.

Attach the lower leg to the seat assembly using the provided hardware as shown.

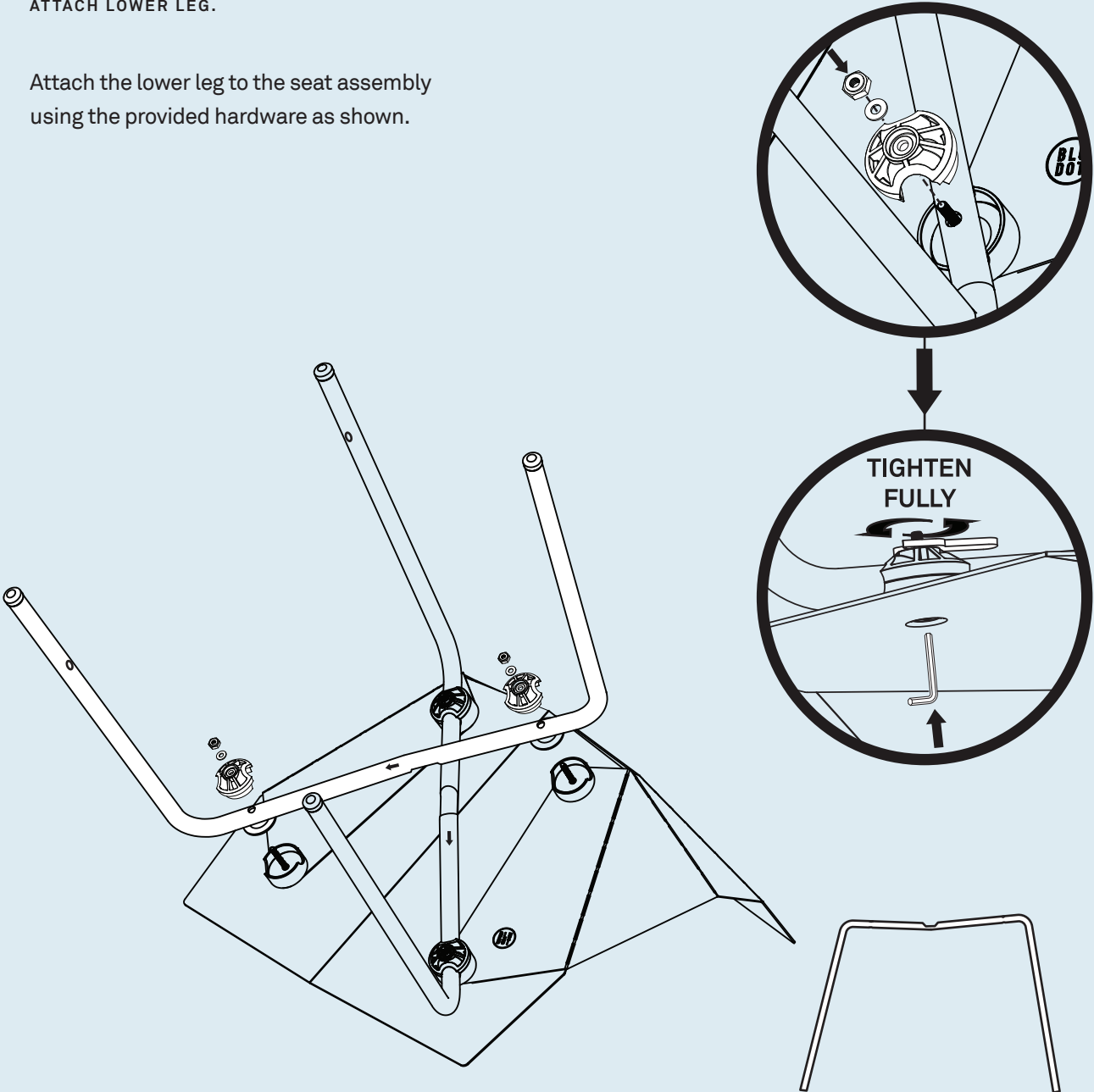

				
PT. 2008 x 2	PT. 3002 x 2	PT. 8033 x 2	PT. 9034 x 1	PT. 9032 x 1

Step 07

ATACH FOOT REST.

Attach foot rest to legs using provided hardware as shown.

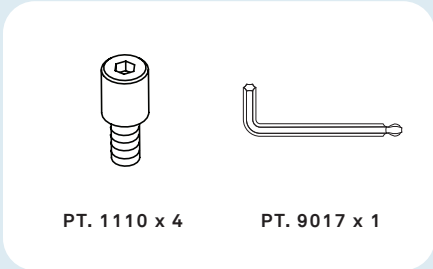
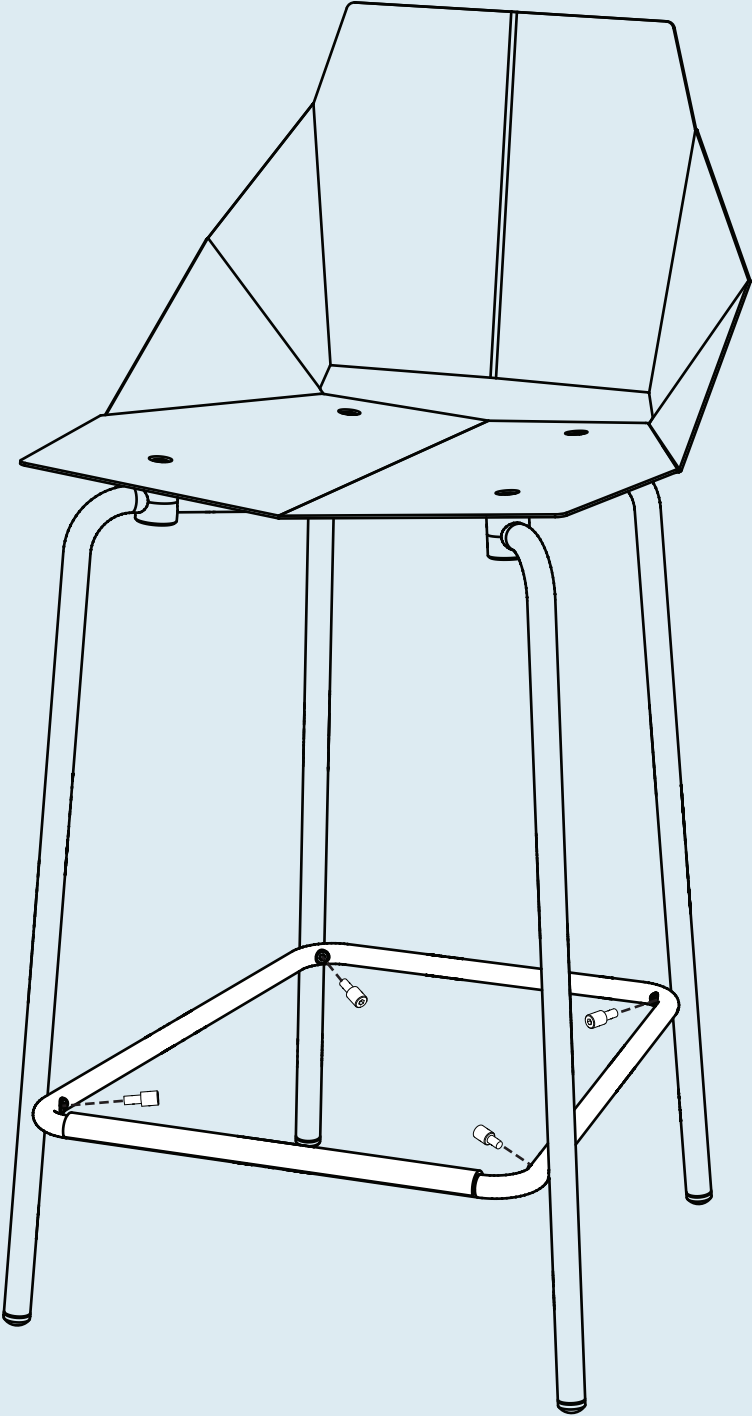

PT. 1110 x 4 PT. 9017 x 1

Step 08

TIGHTEN BOLTS.

Reduce any gaps in the joints by tightening the bolts as shown.

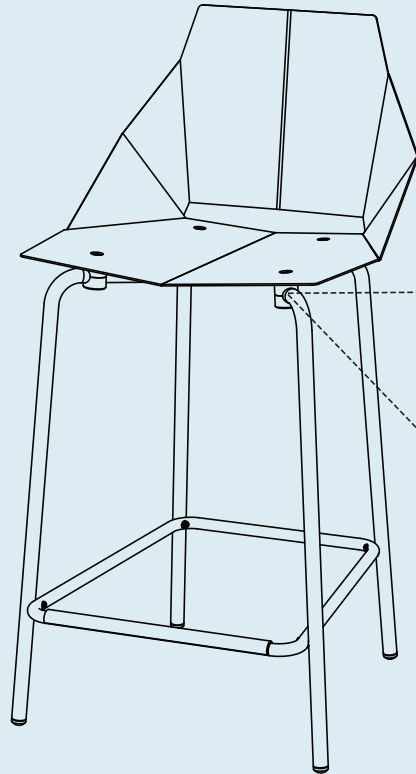

TO REDUCE GAPPING AT (A):
TIGHTEN BOLT (A)
THEN TIGHTEN NUT (B).

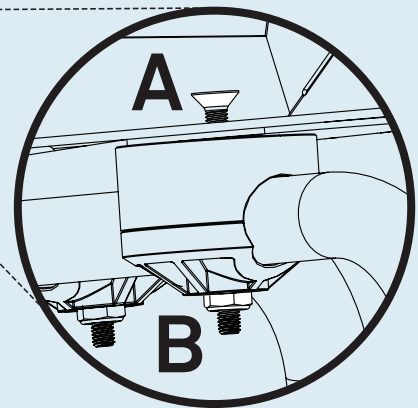

TO REDUCE GAPPING AT (B):
TIGHTEN NUT (B)
THEN TIGHTEN BOLT(A).

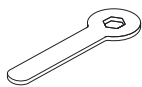

PT. 9034 x 1



PT. 9032 x 1

Additional Information

CLEAN

Clean with a slightly damp, soft cloth. To remove dirt and fingerprints, use a quality cleaner formulated for metal furniture. Wipe completely dry with a soft cloth.

NOTE

The copper finish will be bright when new, and will naturally darken and patina with handling and age.

